



CIRCUIT BREAKER 400V 10KA, 3+N-POLE, C, 32A, D=70MM

Similar to image

**Technical data:**

<b>Overvoltage class</b>		3
<b>type of voltage</b>		AC/DC
<b>Tripping characteristic class</b>		C
<b>Degree of pollution</b>		3
<b>Mounting depth</b>	mm	70
<b>Energy limiting class</b>		3
<b>Number of poles</b>		4
<b>Number of pitch units for width</b>		4
<b>Product function / n-switching</b>		Yes
<b>Supply voltage frequency / rated value</b>	Hz	50
<b>Switching capacity current / in accordance with IEC 60947-2 / rated value</b>	kA	20
<b>Breaking capacity current / acc. to EN 60898 / rated value</b>	kA	10
<b>Supply voltage / for AC / rated value</b>	V	400
<b>Current / for AC / rated value</b>	A	32
<b>Protection class IP</b>		IP20, with connected conductors
<b>Product extension / can be installed / supplementary device</b>		Yes
<b>power loss</b>		-

Operational voltage Um		-
rated current In		-
Rated make-break capacity Icn		-
Rated service short-circuit breaking capacity Ics		-
Rated ultimate short-circuit breaking capacity Icu		-
Tripping characteristics Number		-
Tripping characteristic/-class Conventional tripping current I2, (x In)		-
rated current In IEC, DIN/VDE		-
Tripping characteristic/-class Test current I4, hold (x In)		-
rated current In / IEC, DIN/VDE		
• at 30 Cel	A	32
• at 40 Cel	A	30.72
• at 45 Cel	A	30.08
• at 50 Cel	A	29.44
• at 55 Cel	A	28.48
• at 60 Cel	A	27.84
Resistance against shock / according to IEC 60068-2-27		150m/s <sup>2</sup> at 11ms half-sine

#### Certificates/approvals:

##### General Product Approval



CQC

[IMQ](#)

[ROSTEST](#)



VDE

##### Shipping Approval

other



DNV



GL



LRS



RINA

[other](#)

#### Further information:

##### Information- and Downloadcenter (Catalogs, Brochures,...)

<http://www.siemens.com/lowvoltage/catalogs>

##### Industry Mall (Online ordering system)

<http://www.siemens.com/lowvoltage/mall>

##### Service&Support (Manuals, Certificates, Characteristics, FAQs,...)

<http://support.automation.siemens.com/WW/view/en/5SY4632-7/all>

##### Image database (product images, 2D dimension drawings, 3D models, device circuit diagrams, ...)

[http://www.automation.siemens.com/bilddb/cax\\_en.aspx?mlfb=5SY4632-7](http://www.automation.siemens.com/bilddb/cax_en.aspx?mlfb=5SY4632-7)

##### CAX-Online-Generator

<http://www.siemens.com/cax>

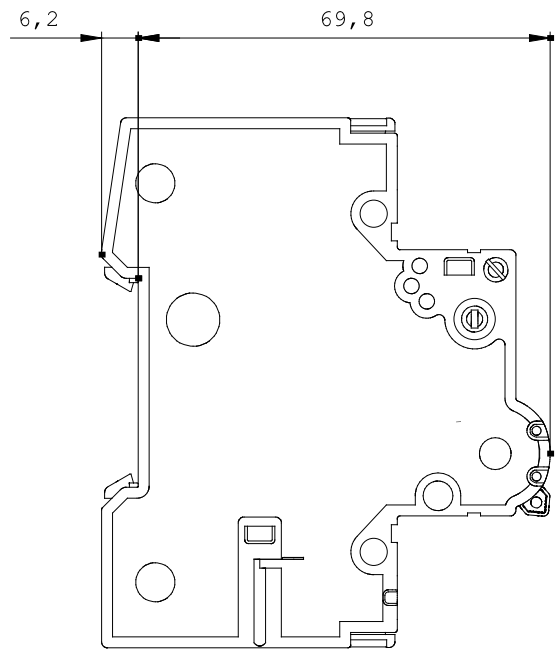
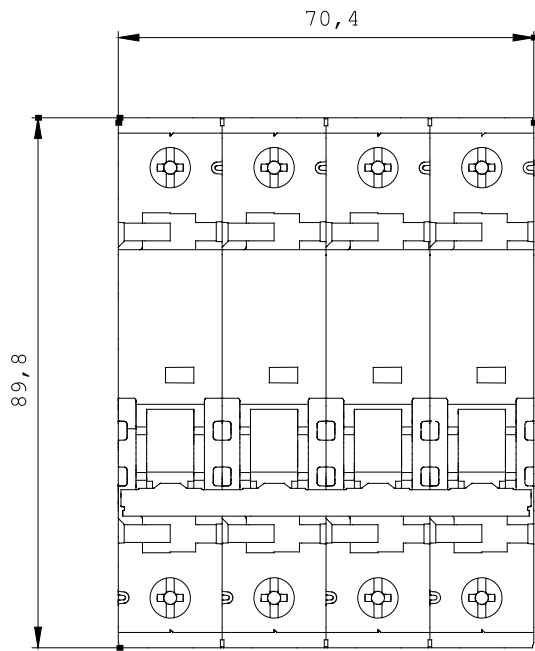

X<sup>1</sup> X<sup>3</sup> X<sup>5</sup> X<sup>N</sup>

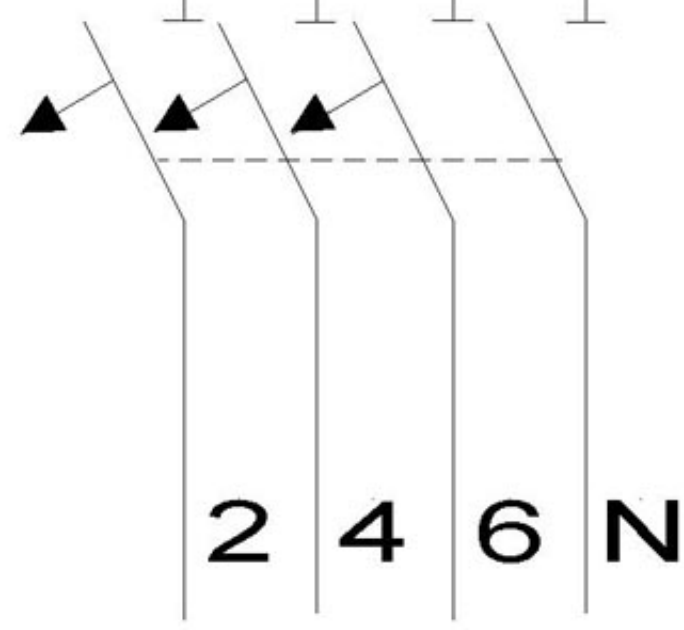

last change:

Nov 3, 2011