



Active Outdoor DVB-T/T2 Antenna

SRT ANT200

User Manual

TABLE OF CONTENTS

1.0 INTRODUCTION	2
2.0 PACKAGE CONTENTS	2
3.0 SAFETY NOTES	4
4.0 CONNECTING THE ANTENNA	4
4.1 To power the antenna with digital terrestrial receiver	5
4.2 To power the antenna with external power adapter	7
5.0 INSTALLATION OF THE ANTENNA	9

1.0 INTRODUCTION

Thank you for purchasing the STRONG SRT ANT200 DVB-T/T2 antenna. This antenna has been specially designed to receive digital terrestrial signals. It can be connected to any Digital Terrestrial Receiver (DVB-T/T2) and is specially designed for outdoor use. The antenna housing is weather-proof sealed. With the supplied multi-functional mounting material, you can install the antenna on any pole outside the house.

This DVB-T/T2 antenna is an "Active type" antenna; it has a built-in low noise amplifier that amplifies the received signal for better performance. The antenna therefore needs 5 V power supplied by your terrestrial receiver, or by an AC/DC adapter (supplied with the antenna).

We recommend that you carefully read this user manual before you install the antenna. This will help you to get the best performance of your antenna.

Specifications

Frequency range:	UHF 470 ~ 862 MHz
Active Antenna Gain:	Max. 18-20dBi for UHF
RF Output Impedance:	75 Ohm
Power Supply:	5 V DC / 45 mA via ANTENNA connector of the digital terrestrial receiver or 5 V DC / 1 mA via External 230 V AC to DC adapter with power injector (included)
2 powering methods:	

Special features:

- Choice of installation method: pole-mounted installation
- Outdoor UHF 18-20dBi TV Antenna for DVB-T/T2 signals reception
- Compatible with DVB-T/T2 receivers supporting active antenna output (5V)*
- External 5G/4G LTE filter included for better reception
- Integrated high gain amplifier for optimal signal strength and performance
- Low V.S.W.R
- Compatible with horizontal and vertical polarizations
- 2-way mounting
- U mounting system, 20 meters RG6 Coaxial cable, 5V inserter for a quick and easy installation
- Durable and weather resistant
- Excellent reception also in harsh environment
- Extremely compact size

*In case 5 V is not supported by the receiver, a power adaptor (included) is required.

2.0 PACKAGE CONTENTS

Fig. 1

Outdoor TV Antenna with integrated amplifier

1. Mount system
2. 5G/4G Filter SRTANT20
3. Short coax cable
4. IEC type male to F type female fast connector
5. Inserter
6. 20 m Black RG6 coaxial cable with IEC male and F-connector
7. 5V Adapter (USB)

Outdoor TV Antenna with integrated amplifier



Mount system



Short coax cable



5G/4G Filter SRTANT20



IEC type male to
F type female
fast connector



20 m Black RG6 coaxial cable with
IEC male and F-connector

Inserter



5 V Adapter (USB)

3.0 SAFETY NOTES

*Be careful working outside with overhead power lines to avoid electrocution.

- Use only originally supplied accessories.
- Before you make any connections: disconnect your equipment from the 230 V main power to avoid electric shocks during installation.
- Short circuit in the coaxial cable **MAY** permanently damage your Digital Receiver.
- Never use AC adapters with incorrect specifications. This **MAY** permanently damage your antenna or Digital Receiver. Always check voltages and polarization of the adapter before connecting it.

4.0 CONNECTING THE ANTENNA

Preparations

1. Check if the broadcast in your country is horizontally or vertically polarised.
2. Fix the antenna to the pole as shown in the picture <Fig. 2>
3. Depending on how the signals are broadcasted (horizontally or vertically) you will have to mount your antenna in the horizontal or vertical position for best performance.
4. Your antenna needs 5 V power to work properly. Check in the menu or user manual of your terrestrial receiver to see if it supports the needed 5 V power.

Fig. 2

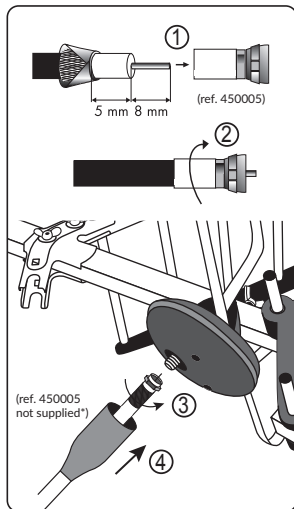

4.1 To power the antenna with digital terrestrial receiver

1. Turn on your TV set and turn on your Digital Terrestrial Receiver.
2. Press the "MENU" button on the remote control of your Digital Terrestrial Receiver. Check in the Set-Up or Installation menu of your receiver to see if the antenna power is set to "ON". (Normally this is indicated in the menu as ANT power, Ext Antenna power or Active antenna power.) Refer to the user manual of your Digital Terrestrial Receiver.
3. Once you are sure that your receiver supports 5 V antenna power, switch off your receiver and disconnect it from the 230 V main power.
4. Take the supplied "long" coaxial cable and connect the end with the "F connector" (screw type connector) to the antenna. Carefully press the inner lead of the cable into the Female-F connector at the back of the antenna. Turn the covering nut clockwise with your HANDS until it is fixed.
5. Connect the IEC Male end to your receiver. Normally the input connector on your receiver is marked as "ANT" (in) or as "RF" (in). Refer to the user manual of your Digital Terrestrial Receiver.
6. Connect your receiver to the 230 V main power and switch ON your receiver and TV set.
7. Proceed to 5.0 "Antenna installation".

Fig. 3

1. Connector: F
2. RF Out
3. Connector: IEC
4. Set-Top Box with 5V output

Option 1

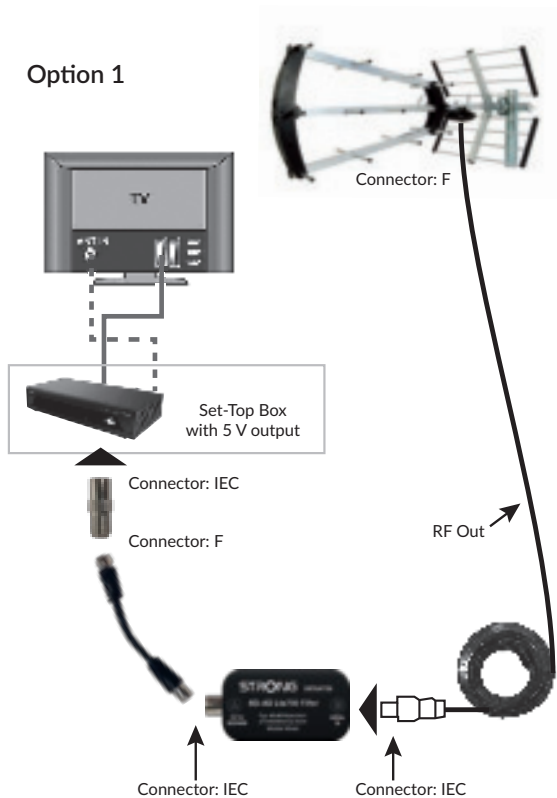

If your receiver does not support 5 V antenna power, then please follow the next steps:

4.2 To power the antenna with external power adapter

1. Switch OFF your receiver and disconnect it from the 230 V mains power.
2. Take the short coaxial (IEC Male to IEC Female) cable. Connect the IEC Male end to your receiver. Normally the input connector on your receiver is marked as "ANT" (in) or as "RF" (in). Refer to the user manual of your Digital Terrestrial Receiver.
3. Connect the other end of the cable to the connector on the power injector that is marked as "Receiver".
4. Take the supplied "long" coaxial cable and connect the end with the "F connector" (screw type connector) to the antenna. Carefully press the inner lead of the cable into the Female-F connector at the back of the antenna. Turn the covering nut clockwise with your HANDS until it is fixed.
5. Connect the other side of the cable to the connector at the power injector, it is marked as "Antenna".
6. Insert the adapter to the 230 V main power and insert the connector at the end of the lead to the power injector - it is marked as "5 V".
7. Proceed to chapter 5 "Installation of the antenna".

Option 2

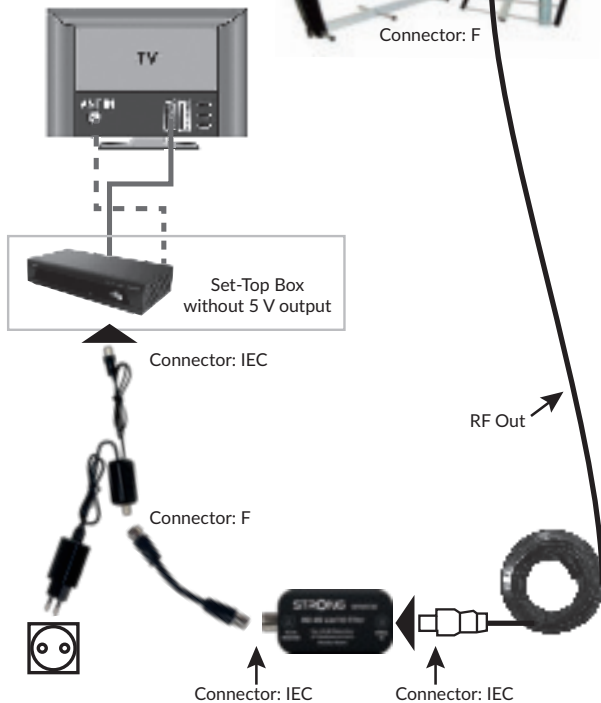

1. Connector: F
2. RF Out
3. Connector: IEC
4. Set-Top Box without 5V output

5.0 INSTALLATION OF THE ANTENNA

1. Turn on your TV set and turn on your Digital Terrestrial Receiver.
2. Press the "MENU" button on the remote control of your Digital Terrestrial Receiver. Select the menu on your receiver that shows the signal level indicators. (Normally you can find the signal meter in the Channel Scan field of the menu). Refer to the user manual of your Digital Terrestrial Receiver.
3. Now optimise the signal strength by finding the best position for the antenna. Keeping the antenna in your hand, try to reach the highest or best possible position. Slowly move the antenna to different positions around the house, at the same time monitor the signal bars in the menu, once the signal indicator shows the maximum signal, fix the antenna on that position.

NOTE:

It is recommended NOT to place the antenna near to:

- Devices that are strong source of radiation or interference such as DECT and GSM telephones, transmitters, microwaves, wifi, etc.
- Devices with high power consumption such as electrical heater, air conditioner, hairdryers, etc.

Once the best position for the antenna has been found it can be mounted and fixed in that place. You can fix the antenna on the wall, on the balcony or on a metal pole.