



IMILAB EC3 Outdoor Security Camera

User Manual

Please read this instruction manual carefully before using the device and retain it for future reference.

Product Introduction

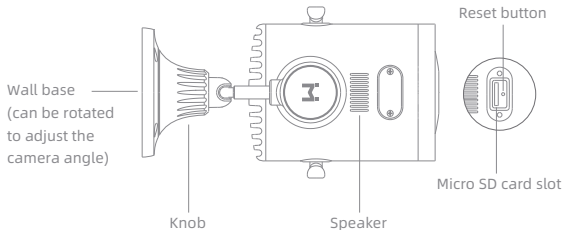

In this instruction manual, images of the device, accessories and user interface are for illustrative purposes only and should only be used for reference.

The actual device may differ from the illustrations due to product updates and upgrades. Please refer to the actual device.

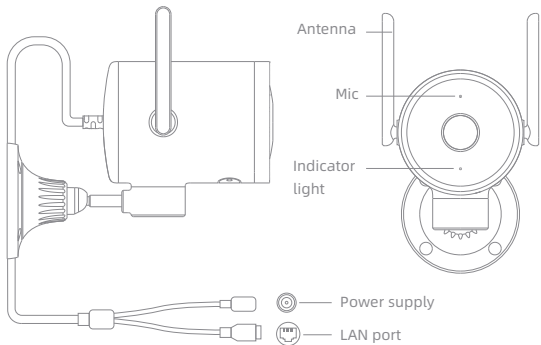

Packing list: IMILAB EC3 Outdoor Security Camera, wall mounting pack, power adapter, waterproofing tape for power/LAN cable, user manual

Installing the Device

Assemble the camera as shown below. Then secure the camera to the metal rod with a screw.

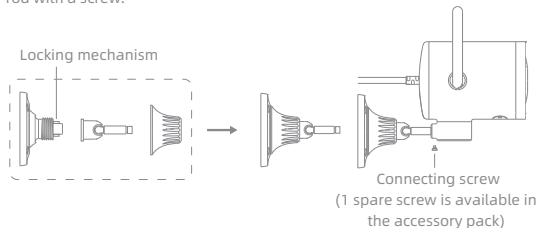

Note: The warranty does not cover any damage caused by improper installation. Please follow the instructions.

Mounting the device

⚠ Note: Please check that the Wi-Fi signal is strong enough before mounting the device.

1. Attach the positioning sticker on the desired installation location. Drill four holes at the positions indicated on the sticker. Drilling diameter of around 6.0mm; drilling depth of around 30mm.

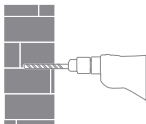
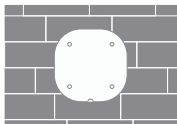

2. Insert four plastic expansion nuts into the holes.

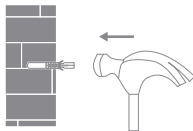

3. Cover part of 2-in-1 power and LAN cable with the base plate as indicated.

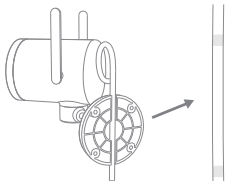

4. Put the base plate on the wall. Ensure that the 2-in-1 power and LAN cable goes straight down. Secure the base plate by inserting the screws into the expansion nuts.

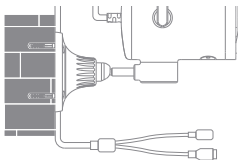

Note:

- In order to prevent accidents and injuries, please secure the device firmly onto the wall as illustrated. The wall on which the device is mounted must have a loading capacity of at least 3 times the weight of the device.
- Do not install the device near a heat source, such as an air-conditioner compressor, air vent of a range hood or air vent of a gas water heater.
- As the camera can be rotated horizontally, please pay attention to the safe turning distance during installation. Do not install the device at a location where its horizontal movement would be impeded.

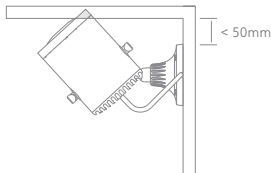
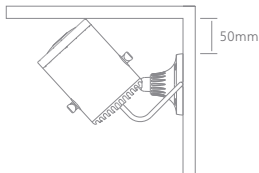

Top view

The distance between the base plate and the wall should be at least 50mm to allow for a safety turning distance. Any gap of less than 50mm will result in an obstruction to the camera's movement.

Waterproofing kit

The camera has a power supply port and a LAN port. Waterproofing must be done on both these ports.

1. Wrap the power supply port with the waterproofing tape as shown below.

2. Wrap the LAN port with the waterproofing tape or a waterproofing sleeve.

- The LAN port can be wrapped with the waterproofing tape in the same way as the power supply port.

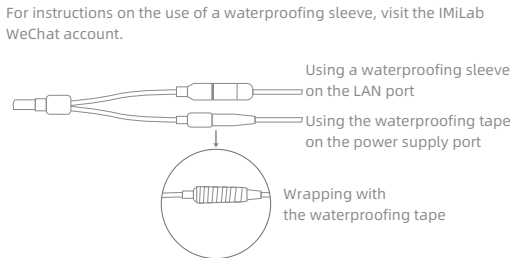

Wrapping with the waterproofing tape

Scan the QR code below to follow the IMiLab WeChat account. Public WeChat account.



Public WeChat
account

Connecting the Device

- Turn on the camera
 - Step 1: Insert the power supply cable into the camera's power supply port. Connect the other end of the power supply cable to a power source.
 - Step 2: When connected to a power supply, the indicator light will show the camera's status. When the indicator light is yellow, the camera is being turned on; when the indicator light is flashing yellow, it is waiting to be connected.
- Insert a micro SD card
 - Ensure that the camera is disconnected from the power supply. Use a screwdriver to remove the protective case and expose the micro SD card slot.
 - The contact points of the micro SD card should be facing the same direction as the camera. Insert the micro SD card into the slot.

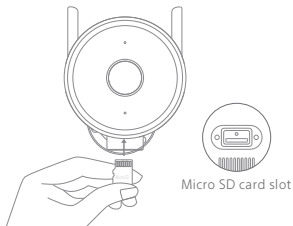

Micro SD card slot

Note:

When inserting or removing the micro SD card, please disconnect the camera from the power supply. Please use a micro SD card from a reputable manufacturer. The recommended read and write speed of the micro SD card is at least U1/Class 10.

- **Restoring factory settings**
Press and hold the reset button to restore the factory settings. The content inside the micro SD card will not be deleted.

Specifications

Name: IMILAB EC3 Outdoor Security Camera

Model: CMSXJ25A

Item Dimensions: 117*91*116mm

Input: 12V $\overline{\text{---}}$ 1A

Net Weight: 495g

Resolution: 1920x1080

Lens Angle: 110°

Operating Temperature: -20°C~ 40°C

Aperture: F1.6

Video Encoding: H.265

Wireless Connectivity: Wi-Fi IEEE 802.11 b/g/n 2.4GHz

LAN Connection: 1 x 10/100M adaptive network port

Compatible With: Android 4.4 or iOS 9.0 or higher

FCC ID: 2APA9-IPC025B

Manufacturer: Shanghai Imilab Technology Co., Ltd.

(a Mi Ecosystem Company)

Address: Room 908, No. 1, Lane 399, Shengxia Rd., China Pilot

Free Trade Zone, Shanghai, China 201210

For further information, please go to www.imilab.com.

Support: help@imilab.com

For Business: globamarketing@imilab.com



MADE IN CHINA

Connecting to Mi Home App

This product works with Mi Home and can be controlled using the Mi Home app.

Scan the QR code to download and install the Mi Home app. If you already have Mi Home app installed, you will be directed to the device connection page. You can also search for "Mi Home" in an app store to download and install the Mi Home app.



About Works with Mi Home

A product that works with Mi Home can be controlled using the Mi Home app. Please note that such products are only verified at the software level. Xiaomi and Mi Home are not responsible for the production, implementation of standards and quality control of these products and their manufacturers.

Note:

The actual operation may differ from the instructions above due to Mi Home app upgrades and updates. Please follow the instructions shown by the Mi Home app.



works with
mija

Infrared Night Vision

The light sensor can automatically switch the device to night vision mode through IR-CUT based on changes in the lighting of the environment. The device features 10 built-in infrared night vision lights that ensure recording stays clear even in darkness.



Infrared night vision effect illustration

Video Playback

Past videos can only be viewed when a compatible micro SD card is inserted in IMILAB EC3 Outdoor Security Camera. After inserting a micro SD card and turning on the device, the camera will automatically start recording.

In the control interface for . in the Mi Home app, tap the playback button to enter the video playback page. You can also view a recording by selected a time period.

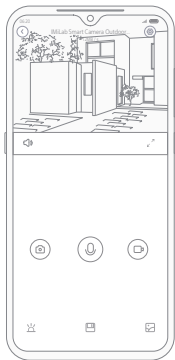

Sharing a Video

In the control interface for IMILAB EC3 Outdoor Security Camera in the Mi Home app, you can set the device as a shared device in the settings menu and invite others to watch the recordings. Users must download the Mi Home app and login to their Xiaomi account in order to view the recordings of the shared device.

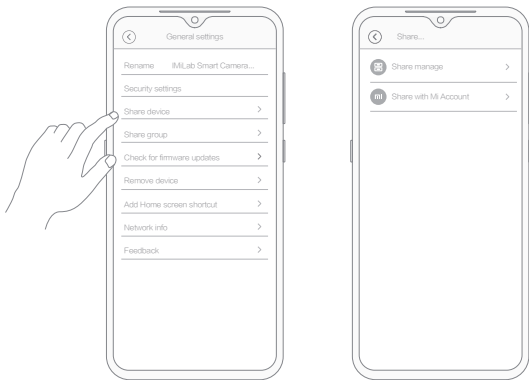

Home Security

- The Home Security function can be turned on/off in the control interface for IMILAB EC3 Outdoor Security Camera in the Mi Home app.
- The device can detect and record movements within the viewing angle and push the recording to the client. Users can set the surveillance time, alert sensitivity, alert interval, etc.

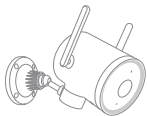

Precautions

- The working temperature of the device is -20°C to 40°C. Do not use the device when the temperature is too high or too low.
- For better results, avoid placing the camera in front of or next to a glass surface, a white-colored wall or other reflective surfaces as this may cause the recording to have un-even lighting between the foreground and background or be over-exposed.
- Please ensure that the device is within Wi-Fi signal coverage. Place it at a location with good Wi-Fi signal strength. Try to avoid placing the device near a metallic object, a microwave oven or other objects that may cause signal interference.

FCC Statement

Changes or modifications not expressly approved by the party responsible for compliance could void the user's authority to operate the equipment. This device complies with Part 15 of the FCC Rules.

Operation is subject to the following two conditions:

- (1) This device may not cause harmful interference, and
- (2) This device must accept any interference received, including interference that may cause undesired operation.

Note: This equipment has been tested and found to comply with the limits for a Class B digital device, pursuant to Part 15 of the FCC Rules. These limits are designed to provide reasonable protection against harmful interference in a

residential installation. This equipment generates, uses, and can radiate radio frequency energy, and if not installed and used in accordance with the instructions, may cause harmful interference to radio communications.

However, there is no guarantee that interference will not occur in a particular installation. If this equipment does cause harmful interference to radio or television reception, which can be determined by turning the equipment off and on, the user is encouraged to try to correct the interference by one or more of the following measures:

- Reorient or relocate the receiving antenna.
- Increase the separation between the equipment and receiver.
- Connect the equipment into an outlet on a circuit different from that to which the receiver is connected.
- Consult the dealer or an experienced radio/TV technician for help.

FCC 20cm Statement: This equipment complies with FCC radiation exposure limits set forth for an uncontrolled environment. This equipment should be installed and operated with a minimum distance of 20cm between the radiator & your body. This transmitter must not be co-located or operating in conjunction with any other antenna or transmitter.

WEEE Disposal and Recycling Information



Correct Disposal of this product. This marking indicates that product should not be disposal with other household wastes through out the EU. To prevent possible harm to the environment or human health from uncontrolled waste disposal, recycle it responsibly to promote the sustainable reuse of material resources. To return your used device, please use the return and collection systems or contact the retailer where the product was purchased. They can take this product for environment safe recycling.

Adaptor Statements

For pluggable equipment, the socket-outlet (power adaptor) shall be installed near the equipment and shall be easily accessible.

Hereby, Shanghai Imilab Technology Co., Ltd. declares that the radio equipment type IMILAB EC3 Outdoor Security Camera is in compliance with Directive 2014/53/EU.

