

DENVER[®]

Instruction manual

DAB-46

www.facebook.com/denverelectronics

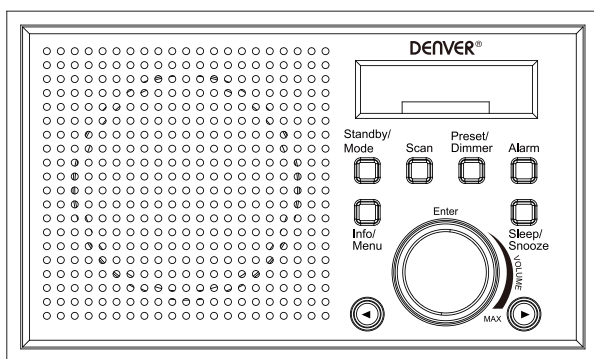

PRODUCT OVERVIEW

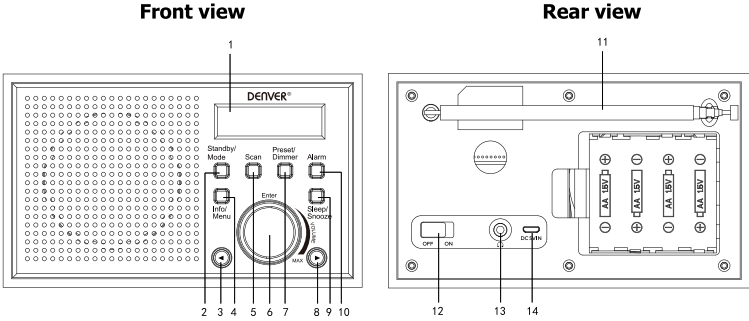

1. LCD DISPLAY
2. STANDBY/MODE BUTTON
3. PREVIOUS BUTTON
4. INFO/MENU BUTTON
5. SCAN BUTTON
6. ENTER/VOLUME KNOB(Confirm the setting/adjust the button)
7. PRESET/DIMMER BUTTON
8. NEXT BUTTON
9. SLEEP/SNOOZE BUTTON
10. ALARM BUTTON
11. ANTENNA
12. OFF/ON BUTTON
13. HEADPHONE JACK
14. DC 5V IN
15. AC/DC ADAPTOR



BASIC OPERATION - GETTING STARTED

The unit can be powered either by AC power or battery.(not incl)

Operation on AC power

1. Insert the DC power jack of AC/DC adaptor to the DC input socket located at the rear of the radio.
2. Plug the AC/DC adaptor to the AC mains outlet.
3. Slide the **ON/OFF** switch to **ON** and press the **STANDBY/MODE** button to turn the radio on.

Warning: Always use the supplied AC power adapter. If the AC Adaptor voltage is more than 5V, product damage or risk possibly occurs.

Operation on battery

1. Ensure the AC/DC adaptor is disconnected from the unit.
2. Load 4 AA batteries in the battery compartment.
3. Press the **STANDBY/MODE** button to turn the radio on.

Note: To obtain the best performance on battery operation, use of alkaline batteries is highly recommended.

Navigation of the menu

The following controls are used to move about the menu tree to choose and select the required settings:

Press and hold the **INFO/MENU** button to enter the menu options. Press the ◀ or ▶ button to navigate the options, then press the **ENTER/VOLUME** knob to confirm.

Description of the menu

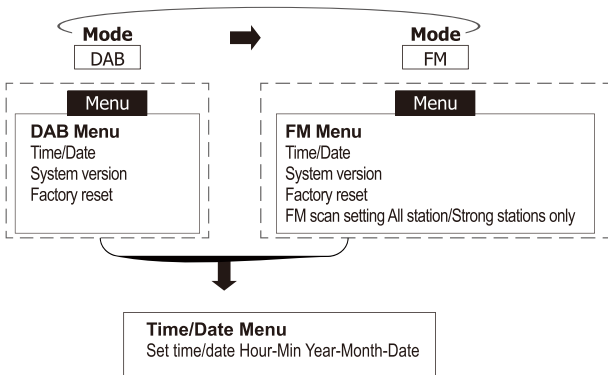

	EN
	Mode
	DAB
	FM
	Menu
	DAB Menu
	Time/Date
	System version
	Factory reset
	FM Menu
	Time/Date
	System version
	Factory reset
	FM scan setting All Strong stations only
	Time/Date Menu
	Set time/date Hour-Min Year-Month-Date

OPERATION OF RADIO

DAB radio

Press the **STANDY/MODE** button to turn the unit on, and press the **SCAN** button to search for all available radio stations. During the scan, the display show "Full scan" together with a slide bar that indicates the progress of the scan and the number of stations that have been found so far (Fig.2).

Once the scan has finished, the radio broadcasts the first alphanumerically found station. You can now press the ◀ / ▶ buttons to select the found stations, then press the **ENTER/VOLUME** knob to confirm selection.

Note: If there is no station found after auto scan, the radio will display "No Station". In this case, adjust the position of the antenna and relocate the unit for better signal reception.

Fig.1

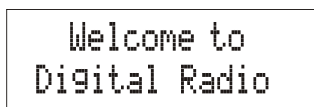
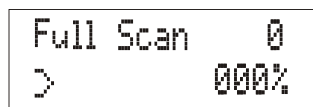

Fig.2



FM radio

1. To select FM, press the **STANDBY/MODE** button. The display shows FM and the frequency.
2. To activate auto search, press and hold the **SCAN** button until the radio starts to scan. The scan stops automatically once a FM station has been found.
3. To search manually, press repeatedly the ◀ / ▶ button to tune to a radio station. If the reception is poor, adjust the position of the antenna and relocate the unit for better signal reception.

FM scan via menu

In **FM** mode, press and hold the **INFO/MENU** button to enter the menu, and press the ◀ / ▶ button to select “FM scan setting” (Fig.3), then press the **ENTER/VOLUME** knob to enter the sub-option. Then press the ◀ / ▶ button to select “Only<All>” (Fig.4), and press the **ENTER/VOLUME** knob to confirm selection for FM scanning.

Fig.3

```

Set Menu
FM Scan setting
  
```

Fig.4

```

Station Strong:
Only <ALL>
  
```

USING HEADPHONES

A stereo headphone jack is available on the unit. Plug your earphones or headphones (not supplied) to the jack marked , and adjust the volume to the reasonable listening level. The speakers of the unit are disabled for output while earphones or headphones are inserted.

Warning: Excessive sound pressure from earphones or headphones can cause hearing loss.

RESET

If you move the unit to another location or another country, the stored DAB stations may no longer be available. In this case, reset the unit to the factory settings.

1. With the unit switched on, press and hold the **INFO/MENU** button to enter the menu, and press the ◀ / ▶ button to select “Factory reset” (Fig.5) , then press the **ENTER/VOLUME** knob to enter the sub-option. Then press the ◀ / ▶ button to select “<Yes>” from the “Factory Reset <No> Yes” option (Fig.6), and press the **ENTER/VOLUME** knob to confirm.
2. The radio displays “Restarting....”, and start searching all available radio stations.

Note: All the previously stored radio stations are deleted after resetting.

Fig.5

```

Set Menu
<Factory reset>
  
```

Fig.6

```

Factory Reset?
<No> Yes
  
```

TECHNICAL SPECIFICATIONS

Rated voltage (adaptor)	AC 100 – 240V~ 50/60Hz, 0.15A
Adaptor output	DC 5V, 1A
Rated voltage (radio)	DC 5V or 1.5V x 4 (4 AA batteries)
Power consumption	5 W
Audio output	2 W RMS
Radio	DAB 174-240MHz FM 87.5-108MHz
Operating conditions Temperature	5°C to 35°C Humidity 5% to 90%
Unit dimension	170 (L) × 96(W) × 101 (H) mm
Weight	0.7kg

SPECIFICATION SUBJECT TO CHANGE WITHOUT FURTHER NOTICE.

ALL RIGHTS RESERVED, COPYRIGHT DENVER ELECTRONICS A/S

DENVER®

www.denver-electronics.com



Electric and electronic equipment and included batteries contains materials, components and substances that can be hazardous to your health and the environment, if the waste material (discarded electric and electronic equipment and batteries) is not handled correctly.

Electric and electronic equipment and batteries is marked with the crossed out trash can symbol, seen below. This symbol signifies that electric and electronic equipment and batteries should not be disposed of with other household waste, but should be disposed of separately.

As the end user it is important that you submit your used batteries to the appropriate and designated facility. In this manner you make sure that the batteries are recycled in accordance with legislature and will not harm the environment.

All cities have established collection points, where electric and electronic equipment and batteries can either be submitted free of charge at recycling stations and other collection sites, or be collected from the households. Additional information is available at the technical department of your city.

Hereby, Inter Sales A/S declares that the radio equipment type DAB-46 is in compliance with Directive 2014/53/EU. The full text of the EU declaration of conformity is available at the following internet address:

www.denver-electronics.com and then click the search ICON on topline of website. Write modelnumber: DAB-46. Now enter product page, and red directive is found under [downloads/other downloads](#)

Operating Frequency Range: DAB 174-240MHz

FM 87.5-108MHz

Max Output Power: 5 W

DENVER ELECTRONICS A/S

Omega 5A, Soeften

DK-8382 Hinnerup

Denmark

www.facebook.com/denverelectronics

DAB Radio Signal

Please notice that DAB signal can be weaken MUCH depending on the type of building you are living in. For example, it can be hard to catch proper signal when being in a concrete building.

Signal can also be different in different areas of the country. Please check your local transmitter to get the best signal in your area.

Vær opmærksom på at det kan påvirke DAB signalet MEGET hvilken type bygning man bor i. Det kan f.eks. være svært at få et ordentligt signal hvis man bor i beton byggeri.

Der er også forskel på hvor god dækningen er i forskellige områder. Tjek nyeste dækningskort på www.dabradio.dk under "hvad er digital radio".